

**▶M.PRO**  
PROFESSIONAL MEDIA  
**PV-1200**

# User Manual

## Power Amplifier

PUBLIC ADDRESS SYSTEM



CAUTION: Do not open the equipment cover arbitrarily,  
so as not to electric shock. Please contact the professionals  
to maintain if necessary .

**LIMITED WARRANTY**

We warrant that the hardware products it manufactures will be free from defects in materials and workmanship.

The warranty term, beginning on the date of invoice, is one year for Parts replacement, two years for parts repair and six months on accessories.

This warranty does not cover damage or failure caused by alterations, mishandling, abuse, misuse, neglect, accident or resulting from any cause other than a product defect.

In case of defects in material and workmanship under normal use and conditions, we will replace or repair products covered under this limited warranty that are returned to our facility.

To request warranty service, you must contact our international sales team within the warranty period, ship the products back to us in their original or equivalent packaging (freight prepaid). If we repair or replace a product, its warranty term is not extended.

**DISCLAIMER**

Information contained in this manual is subject to change without prior notice and does not represent a commitment on the part of the vendor. We shall not be liable for any loss or damages whatsoever arising from the use of information or any error contained in this manual.

It is recommended that all services and repairs on this product be carried out by us or its authorized dealer.

This product must only be used for the purpose it was intended by the manufacturer and in conjunction with this operating manual.

We cannot accept any liability whatsoever for any loss or damages caused by service, maintenance or repair by unauthorized personnel, or by use other than that intended by the manufacturer.

Thank you for purchasing the **High Power Amplifier**. Please carefully follow the instructions in this manual to ensure long, and trouble-free use of the equipment.

**Accessories**

AC power cord .....1  
 User manual .....1  
 Warranty card .....1

**Safety Precautions**



The lightning flash with arrowhead symbol, within an equilateral triangle, is intended to alert the user to the presence of uninsulated "dangerous voltage" within the product's enclosure that may be of sufficient magnitude to constitute a risk of electric shock to persons.



The exclamation point within an equilateral triangle is intended to alert the user to the presence of important operating and maintenance (servicing) instructions in the literature accompanying the appliance.

**CAUTION**

Indicates a potentially hazardous situation which, if mishandled, could result in moderate or minor personal injury, and/or property damage.

- Before installation or use, be sure to carefully read all the instructions in this section for correct and safe operation.
- Be sure to follow all the precautionary instructions in this section, which contain important warnings and/or cautions regarding safety.
- After reading, keep this manual handy for future reference.

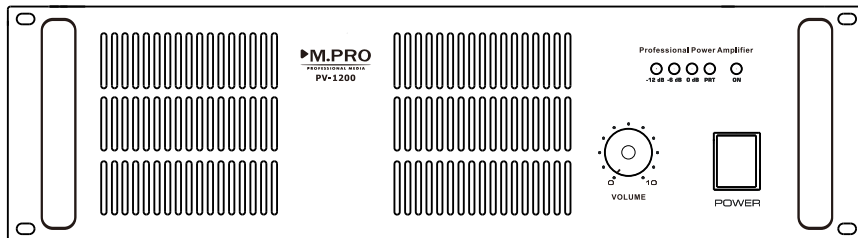

## Descriptions & Features

The Series of PA Power Amplifiers are designed for background music/paging and public address system installations, these units are exceptional values, loaded with features, and are easy to install in a variety of system designs.

The PA power amplifiers are designed to operate under a variety of conditions without fail, models with much higher power support the conditions where high power level of speakers or group of speakers are needed.

The power amplifiers features one line input or one line output, 1200 watts with either 70/100-volt or 4-16 ohms( $\Omega$ ) loads. And features many of the same comprehensive protection circuits typical, complete protection is provided for output short circuit, overload, high temperature, peak current limiters.

- ※ RCA and XLR socket for convenient link.
- ※ 70V, 100V and 4~16 $\Omega$  outputs.
- ※ Output short circuit, overload, high temperature protection and alarm.
- ※ Included a balanced line level output for adding additional power amplifiers.

## Installation Notes

1. This amplifier is used in PA system, should be located in the good ventilation place, do not lay in the surrounding of high temperature.
2. Do not expose the equipment under the rain or the surrounding with water and other liquid, so as not to cause fire or electric shock.
3. Please use under specified voltage (AC220V/50Hz). It may cause fire or electric shock when the voltage value higher than the specified.
4. Do not cut off or change the power cable, so as not to cause damage, additionally, do not let the power cable near the heater, also do not lay the heavy object which include the equipment on the cable, so as not to cause fire or electric shock.
5. After finishing speaker connection, please be sure to recover the protection cover in the output port, because it can reach to 100V output voltage in the output port, so do not touch these ports, so as not to be electric shock. And these ports can not as the power of other equipments.
6. Do not install or lay this equipment on the location of instability, such as shaking or skew of the table, lest equipment falling and causing injury to persons or damage to equipment and property.
7. If the hand is wet, please do not use hand directly to insert or pull out the power plug, it may cause electric shock.
8. If you want to pull out the power plug, be sure to hold the plug, do not hold cable. when the power cable damaged, using this equipment may cause fire or electric shock.
9. If you want to move the equipment, please be sure to pull out the plug from the socket.
10. Do not block the ventilation place on the equipment shell, otherwise it may cause internal overheating and fire.
11. Do not install this equipment in the place where has humidity, more dust, direct sunlight, heater, soot, vapor, otherwise it may cause fire and electric shock.

**Operation Notes**

1. This equipment has passed the strict inspection, however, you should turn off the power, pull out the power plug when discover some following anomalies in case, and contact the dealer.
  - A. If smelled smoke and peculiar smell which set out from the equipment.
  - B. If water or any metal immerge or fall into the equipment.
  - C. If the equipment fell or the shell damaged.
  - D. If the power cable damaged.
  - E. If the equipment failed.
  - F. If the equipment distorted badly.
2. This equipment contains high voltage components, please do not arbitrarily open, so as not to cause fire or electric shock, if need to maintain, please contact dealer or professionals to handle
3. Do not lay liquid container or metal on the equipment top, if they fall into the equipment, it may cause fire or electric shock
4. Do not fall metal or flammable object into the ventilation slot, so as not to cause fire or electric shock. Do not touch the power plug when thundering and fulmination, so as not to cause injury of electric shock .
5. Do not lay heavy object on the equipment top, so as to avoid falling or damage, and even cause injury to persons or damage to equipment and property, in addition, heavy object falling itself may cause injury or damage
6. If found voice distortion situation, please do not operate this equipment for long time, this is also a fault alarm message, if use unceasingly ,it may cause overheating and fire.
7. To clean equipment, please contact with the dealer, if the dust accumulated in the equipment for long time, it may cause fire or damage.
8. Lay this equipment on a stable location, and make a appropriate treatment to prevent falling, otherwise it may cause the equipment falling, and cause injury to persons or damage to equipment and property.
9. So as to avoid the inner temperature to rise, the equipment should be 10 centimeter far from the barrier.

**Front Panel**

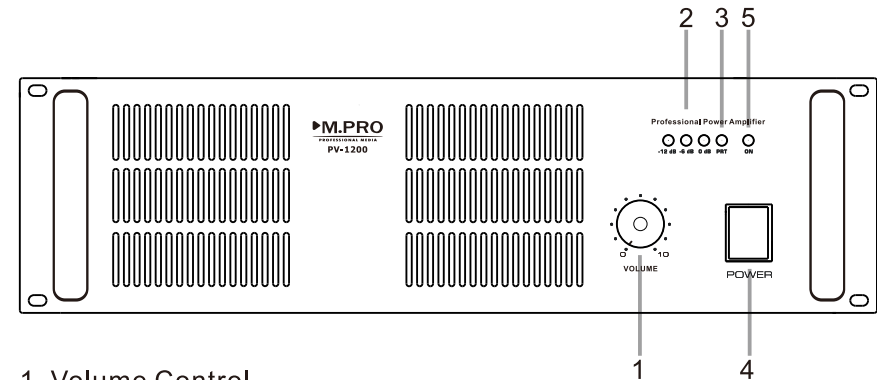

1. Volume Control
2. Signal Indicator
3. Protection Indicator
4. Power Switch
5. Power Indicator

**Rear Panel**

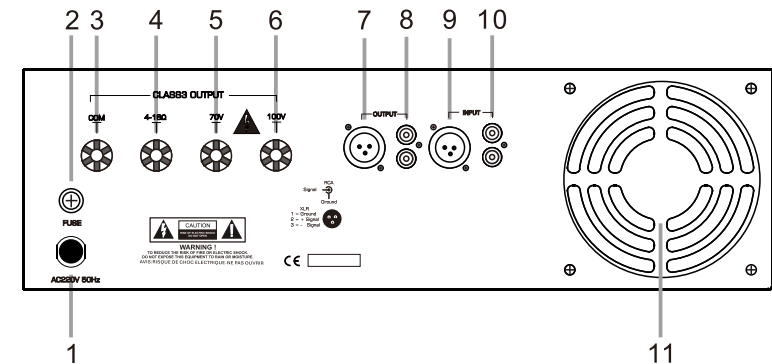

1. AC Power Inlet
2. Fuse
3. COM speaker terminal
4. Speaker terminal 4-16Ω
5. Speaker terminal 70V
6. Speaker terminal 100V
7. XLR signal output
8. RCA signal output
9. XLR signal input
10. RCA signal input
11. Ventilation outlet

3-pin XLR Connector

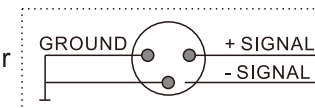

**Connection Illustration**

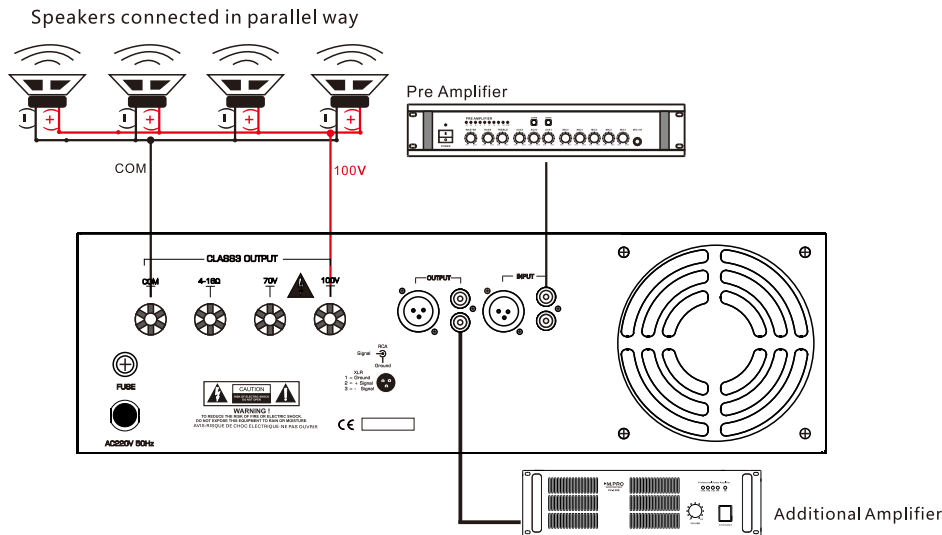

**IMPORTANT NOTES**

**Before you connect the speakers, please read below notes:**

This amplifier has different loudspeakers outputs of 100V, 70V and low impedance 4-16Ω. It's only possible to use one output at the same time, connecting more than one may damage internal parts of the amplifier, Each of 100V, 70V, 4-16Ω terminals must work with COM (common) terminal.

**100V line output**

This system is most commonly used in for PA system. Only use 100V line loudspeakers with transformers. All loudspeakers are wired in parallel and the sum of their power must not exceed the rated output power of the amplifier. It is advisable not to load the amplifier at more than 70% of its rated output power when using music sources.

**70V line output**

This system is common in the USA, it operates on the same principles as 100V line except that at rated output power the amplifier has 70V RMS on its output terminals.

**4-16Ω low impedance output**

This output allows connection of low impedance loudspeakers without transformers, When two or more loudspeakers are used ensure that they are wired in such a way in Series, or in Parallel, or in Series & Parallel Combination that total load impedance remains 4Ω and 16Ω.

**Specifications**

Model	PV-1200
Rated Power	1200W
Output Terminals	Low impedance:4-16 ohms(Ω); 7Voltage line:70V,100V
XLR Input	1.2V
AUX Output	0.775V (0 dBV)
Freq. Response	60Hz ~ 20kHz (-1 dB)
THD	<0.5% at 1kHz,1/3 of rated power
S/N	>100 dB
Damping Factor	600
Controls	Volume controls,power control
Cooling Fan	DC 24V FAN
Indicator	Power, signal level, protection
Protection	AC FUSE×20A
	AC FUSE×1,short circuit,overload,high temperature
Power Cord	(3×1.5 mm <sup>2</sup> )×1.5M (standard)
AC Power	AC220V 50Hz
Consumption	1950W
Dimension	132(H)×486(W)×483(D) mm
Packing Size	225(H)×565(W)×550(D) mm
Net Weight	23.00kg
Gross Weight	25.50kg